

CSP Flat Roof Smoke Ventilation



CSP is an electrically operated smoke ventilation roof window for installation in flat roofs 0°-15° which makes it an ideal product for providing automatic smoke ventilation within stairwells or lobbies. Smoke sensors (KFA 100), control systems (KFX 110) for operation of one window or (KFX 120) for operation of two windows, and break glass units (KFK 100) are purchased separately.

The smoke ventilation roof window can be operated via the smoke sensor (KFA 100) or break glass point (KFK 100).

Applications

Operation

Maintenance

- The cable itself cannot be replaced if damaged. The cable and motor must be replaced as a complete unit.
- It is recommended to lubricate the window hinges at least once a year.
- The smoke ventilation system must be tested after installation, service work and alterations to the system. It must be inspected by qualified personnel at least once a year. Tests and inspections must be documented in accordance with national regulations.
- Disconnect the power supply before carrying out any maintenance or service work to the smoke ventilation window and ensure that it cannot be reconnected unintentionally during this time.

10 year VELUX guarantee for the windows and parts and blinds

3 year guarantee for the electrical items

Guarantee

(--73) Toughened outer pane with clear and clean coating on the external pane and laminated inner pane recommended by VELUX for additional safety.

Variants

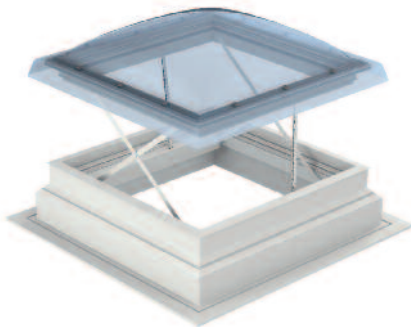

Flat roof Smoke Ventilation window requires:

Control systems (KFX 110) for operation of one window or (KFX 120) for operation of two windows. PURCHASED SEPARATELY

Smoke Sensors (KFA 100). PURCHASED SEPARATELY

Break glass units (KFK 100). PURCHASED SEPARATELY

Requirements

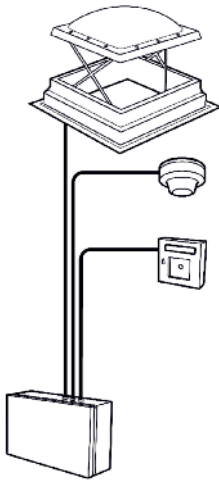

[Click here](#) for more information on Smoke Ventilation Windows.

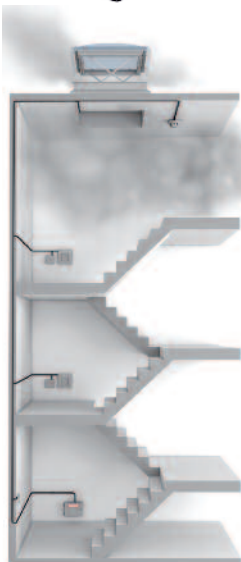

Technical data – Flat Roof Smoke ventilation system – CSP

Measurements (mm)

Size	Exterior frame W x H	Roof opening a x b	Visible glass e x f	Lining rebate k x l
100100	1180 x 1180	1000 x 1000	835 x 835	959 x 959
120120	1380 x 1380	1200 x 1200	1035 x 1035	1159 x 1159

Cross-section/measurements (mm)

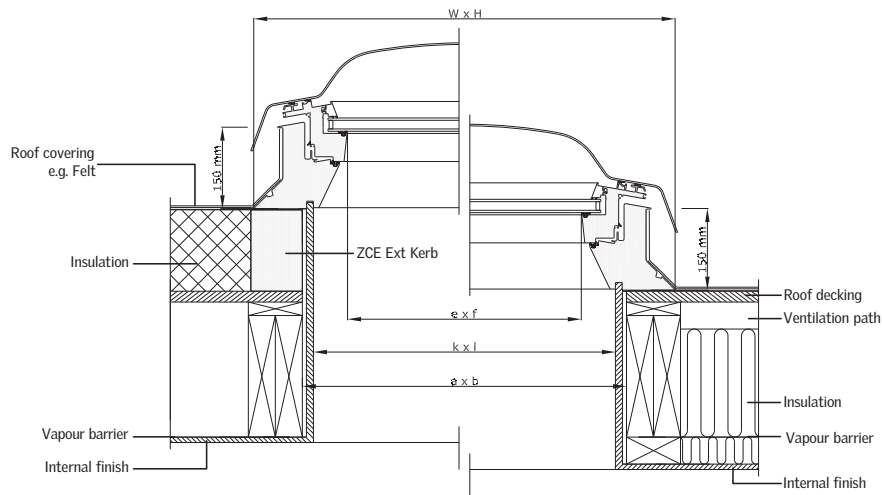

Typical wiring diagram

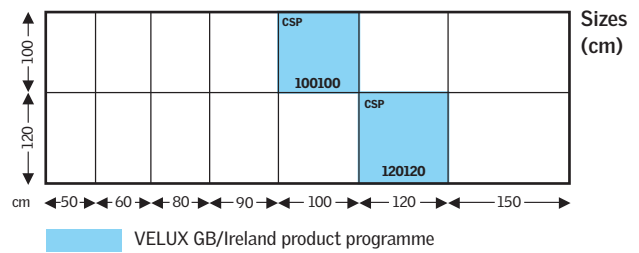
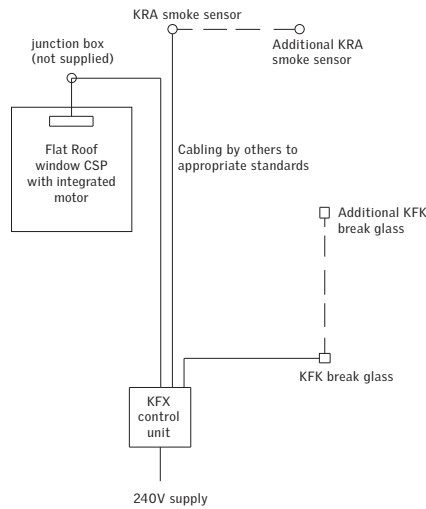

Technical data

	Size	100100	120120
Smoke Ventilation – open window [m ²]		0.88	1.30
Effective Daylight area [m ²]		0.70	1.07

Pane variant --73	CSP clear	CSP opaque	EN/ISO Standard
Thermal transmittance,	2.7	2.7	EN 1873
Thermal transmittance for Dome U _v [W/m ² K]	N/A	N/A	N/A
Sound insulation, R _v [dB]	33	33	EN ISO 140-3
Rain noise sound intensity level	46	46	EN ISO 140-18
Air permeability	Class 4	Class 4	EN 12153
Luminous transmittance, τ _{D65}	0.68	0.21	EN 1873
Total solar energy transmittance, g	0.51	0.21	EN 410